

**WA 400-10 P**

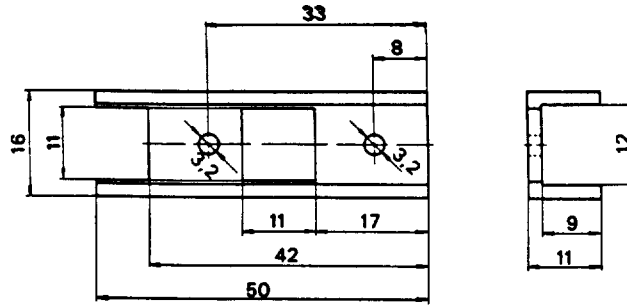

Matériel: Alu anodisé noir  
Résistance thermique: 16 °C/W

**WA 400-11 P**

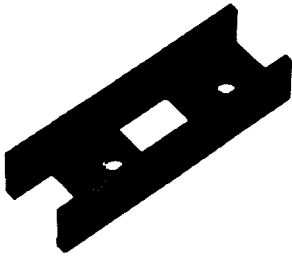
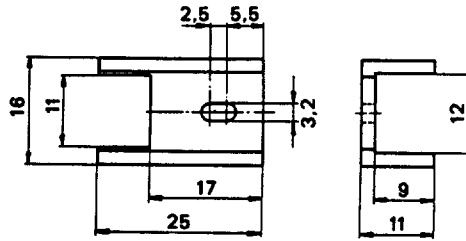

Matériel: Alu anodisé noir  
Résistance thermique: 18 °C/W

**WA 403-8  
(TO-3)**

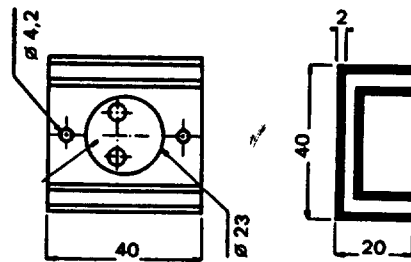

Matériel: Alu anodisé noir  
Résistance thermique: 9 °C/W

**Intercalaires isolantes**

**TP 101 (TO-5)**

Matériel: Ultramid BS 3  
T<sub>max.</sub>: 120 °C

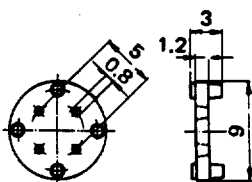

**TP 102 (TO-18)**

Matériel: Ultramid BS 3  
T<sub>max.</sub>: 120 °C

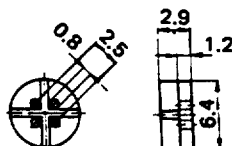

**TP 104 (TO-5)**

Matériel: Polyamid  
T<sub>max.</sub>: 120 °C

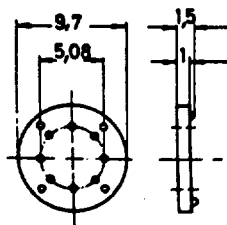

**TP 105 (TO-5)**

Matériel: Polyamid  
T<sub>max.</sub>: 120 °C

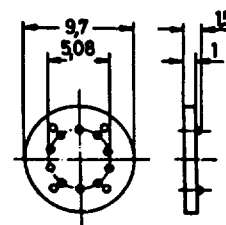

**TP 106 (TO-5)**

Matériel: Polyamid  
T<sub>max.</sub>: 120 °C

