

## WA 362

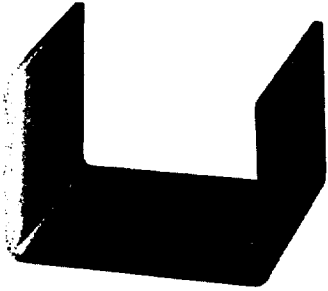

### WA 362-2

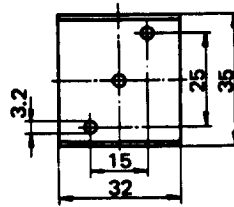
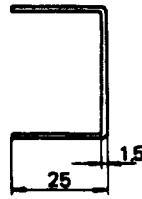

Type	Perçage
WA 362-2	TO-66 P TO-220
WA 362-6	-
WA 362-8	TO-3
WA 362-8P	TO-220
WA 362-9	TO-66
WA 362-9P	TO-202

Matériau: Alu anodisé noir  
Résistance thermique: 11°C/W

### WA 362-8 (TO-3)

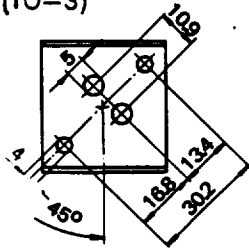

### WA 362-9 (TO-66)

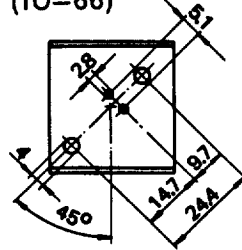

### WA 362-8 P (TO-220)

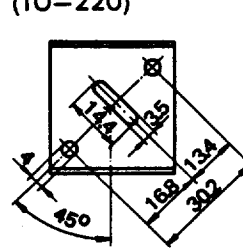

### WA 362-9 P (TO-202)

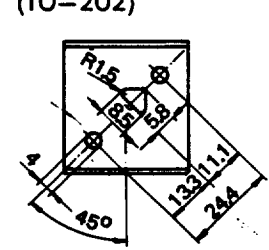

## WA 400-8 P

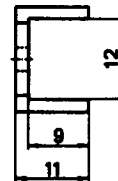
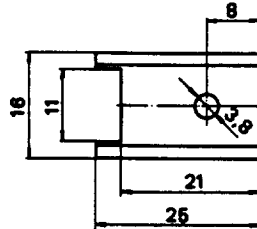
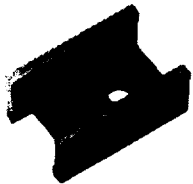

Matériau: Alu anodisé noir  
Résistance thermique: 18°C/W

## WA 400-9 P

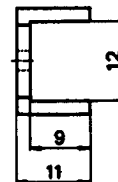
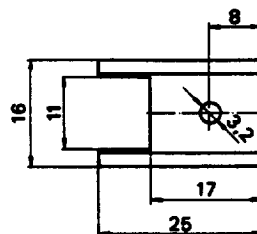
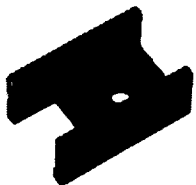

Matériau: Alu anodisé noir  
Résistance thermique: 18°C/W