

# Specification Guide Codes:

**A** = Item Number

**B** = Rated Current

**C** = Insulation Resistance At 500 V DC

- Contact : Brass, Tin / Nickel Plated

- With Other Wire Size Or Lengths Available On Special Order.

- To Install Fuses With "Loop" Type Wires, Simply Cut Loop Into Two Separate Wires Of Desired Length.

**D** = Contact Resistance

**E** = Dielectric Strength For 60 Seconds

**F** = Body Material

**G** = Supply Standard UL Wire-AWG/Length

### IN-LINE FUSE HOLDER

#### CQ-520B



**B:** 15A  
**C:** 100MΩ Min  
**D:** 5mΩ At 1A DC  
**E:** AC2000V Min.  
**F:** Bakelite  
**G:** 16#AWG / 8"Loop  
**Screw Type**

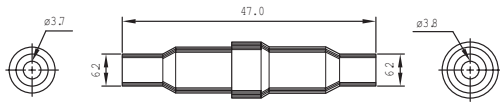

#### CQ-632B



**B:** 15A  
**C:** 100MΩ Min  
**D:** 5mΩ At 1A DC  
**E:** AC2000V Min.  
**F:** Bakelite  
**G:** 16#AWG / 8"Loop  
**Screw Type**  
 In-Line Fuse Holder For  
 1/4"x1-1/4 Fuses

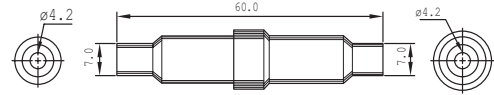

### IN-LINE FUSE HOLDER FOR 1/4"x1-1/4 (6.3x32mm or 6.3x30mm) FUSES

#### CQ-209B

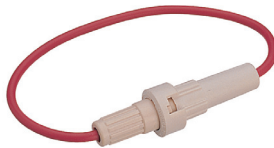

**B:** 20A  
**C:** 100MΩ Min  
**D:** 5mΩ At 1A DC  
**E:** AC1500V Min.  
**F:** A.B.S.  
**G:** 14#AWG / 8"Loop  
**Bayonet Type**

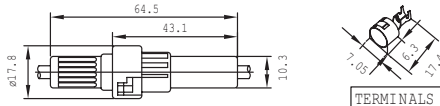

#### CQ-209D

**RoHS**

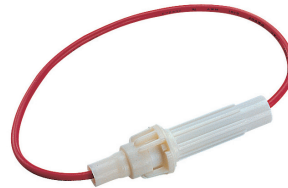

**B:** 20A  
**C:** 100MΩ Min  
**D:** 5mΩ At 1A DC  
**E:** AC1500V Min.  
**F:** Nylon  
**G:** 14#AWG / 8"Loop  
**Bayonet Type**

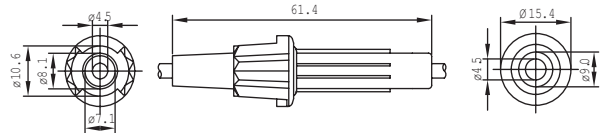

#### CQ-209F1

**RoHS**



**B:** 10A  
**C:** 100MΩ Min  
**D:** 5mΩ At 1A DC  
**E:** AC1500V Min.  
**F:** P.P.  
**G:** 18#AWG / 8"Loop  
**Hinged Body Type**  
 Only For 6.3x30 mm Fuses

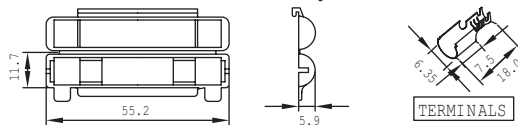

#### CQ-209F2



**B:** 10A  
**C:** 100MΩ Min  
**D:** 5mΩ At 1A DC  
**E:** AC1500V Min.  
**F:** P.V.C.  
**G:** 18#AWG  
**Snap-Lock Type**

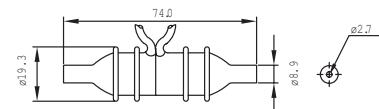

#### CQ-209F3

**RoHS**



**B:** 15A  
**C:** 100MΩ Min  
**D:** 5mΩ At 1A DC  
**E:** AC1500V Min.  
**F:** Nylon  
**G:** 16#AWG / 8"Loop  
**Hinged Body Type**

