

Round, bus bar type

Series: BCAP



Features:

- > Over 500,000 duty cycles
- > 10 year life capability
- > Higher energy vs electrolytic
- > Higher power vs. batteries
- > Aluminum construction
- > Round, double ended design
- > Ultra-low internal resistance
- > Resistant against reverse polarity



Applications:

- > Automotive subsystems
- > Heavy duty vehicle subsystems
- > Rail system power
- > Windmill pitch control systems
- > Wireless transmissions

Dimensions:

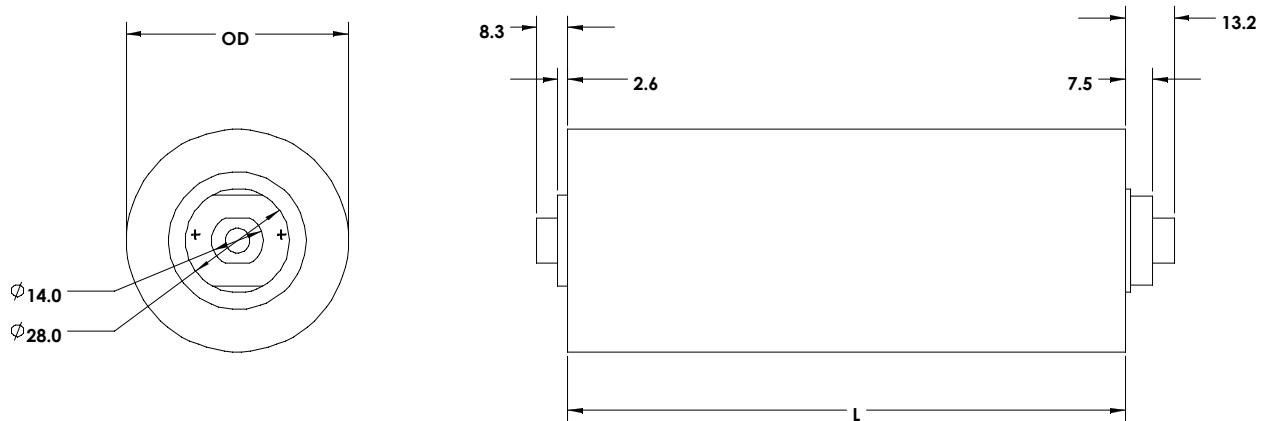

Case size	Dimensions, mm		Weight [g]	Vol. [l]	Typical package qty
	L	OD			
BCAP0013	75	50	190	0.15	25

**NOTE: BCAP0013 available in limited quantity only.
The BCAP0350 is the replacement part for this product.
Please contact BOOSTCAP Sales for additional information.**

Product dimensions and specifications may change without notice. Please contact Maxwell Technologies directly for any technical specifications critical to application.

› **Specifications:**

NOTE: BCAP0013 available in limited quantity.

	Product Specification		Standard
	BCAP0013	Tolerance	
Mounting	Screw Type		
Capacitance, C _R [F]	450	+/- 20%	
Voltage, U _R	2.5		
Internal resistance, DC [ohm]	0.0024	+/- 25 %	
Internal resistance, 1 kHz [ohm]	0.0008	+/- 25 %	
Rated current, [A]	180		5s discharge to 1/2 U _R
Short circuit current, I _{sc} [A]	3000		Caution , current possible with short circuit from U _R
Leakage current [mA]	3		72 hrs, 25°C
Operating temp. range [C]	-40 to 65		
Storage temp. range [C]	-40 to 70		
Endurance, Capacitance [F]	< 20% decrease		1000 hrs @ U _R and 70°C
Endurance, Resistance [ohm]	< 40% increase		
Maximum energy, E _{max} [mAh]	300		Full discharge from U _R
Power, P _d [W/kg]	1640		See additional technical information
Power, P _v [W/l]	2080		See additional technical information
Life Time	ΔC < 20% decrease, ESR < 200% increase		from initial value after 10y @ 25°C
Cycle Life	ΔC < 20% decrease, ESR < 200% increase		from initial value after 500K cycles @ 25°C (I = 20A)

› **Markings: Capacitors are marked with the following information**

Rated capacitance, Rated voltage, product number, name of manufacturer, positive and negative terminal, warning marking

› **Mounting Recommendations:**

Maximum torque for M8 screw terminals is 7Nm with one key and 10Nm using a counter key. See B-F0-0130 for additional information.

Components should not be operated outside recommended limits.

› **Additional Technical Information:**

$$P_d = (0.12 \times E^2 / R_d) / M$$

where E = charge voltage (U_R),
M = capacitor weight (kg)

R_d = internal resistance (DC)

$$P_v = (0.12 \times E^2 / R_d) / V$$

where V = capacitor volume (l)

US Patents: 6,525,924

Worldwide Headquarters

MAXWELL TECHNOLOGIES
9244 Balboa Avenue • San Diego, 92123 CA, USA
PHONE: +(1) 858 503 3300
FAX: +(1) 858 503 3301
EMAIL: info@maxwell.com

European Office

MAXWELL TECHNOLOGIES SA
CH-1728 Rossens • Switzerland
PHONE: +41 (0) 26 411 85 00
FAX: +41 (0) 26 411 85 05
EMAIL: info@maxwell.com

